



MACHINE 2010

Structure 140 x 140 x 8 mm.
 Tray 1200 x 600 mm.
 Vibration non-stop, inverter.
 15 cv 2 columns x 80 mm.
 Tray injector with speed control.
 Production from 50 mm to 300 mm.
 Hydraulic equipment.
 Machine weight: 6.800 kg.



CIRCUIT

Elevator of 8 trays.
 Operation non-stop.
 Liftcar with driver.
 Geared motor with two exit.
 Tray brush.
 Tray turn (optional).
 Metallic shelves system.



MIXER

Mixer 560 liters. 15 cv, with skip.
 Planetarium, 3 arms.
 Hydraulic door.
 Protection plates of 12 mm replaceable.



CONTROL EQUIPMENT

Scada for controlling installation.
 Visual control of installation.
 On-line assistance.
 PLC, Inverter Lenze brand...



PACKING

Packing portic type full automatic.
 All movements with frequency inverter.
 Turn 90 - 180 grades with gearwheel.
 Closing by 4 sides. Pump motor.



AGGREGATES

2 or 3 hoppers. 45 m³.
 Aggregates weight automatic/programmable.
 Cement weight by load cell.

Block making machines since 1956



ROMETA 2010

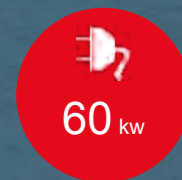

INSTALLATION ROMETA 2010 TO PRODUCE BLOCKS, CEILING, BLOCKS, PAVERS.
 EASY ASSEMBLING AND USE. FULL AUTOMATIC.

PRODUCTION

Tray 1200 x 600 mm



5 blocks 40 x 20 x 20	900 pieces / hour
6 ceiling blocks 54 x 15 x 20	1050 pieces / hour
25 pavers 20 x 10	90 m ² / hour
Max. height	300 mm
Min. height	60 mm



BUILDING AND LAND

Building: approx. 800 sqm
 Stock area: approx. 600 sqm
 Power: 60 Kw



ROMETA 2010-10

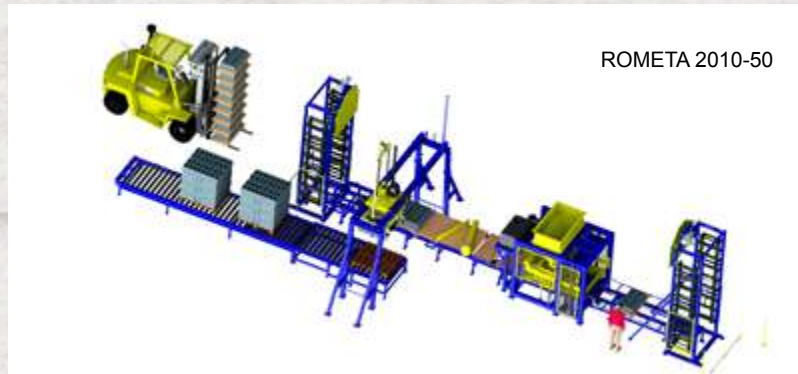

ROMETA 2010-50

ROMETA S.A.
 Zona industrial
 Ronda de les conques, 21-23
 08180 MOIA
 BARCELONA - SPAIN

Phone: + 34 93 820 81 81
 + 34 61 617 35 85
 Email : rometa@rometa.es
 Skype : montse-rometa
 www.rometa.es



Non contractual document.



ROMETA 2010-60



Control equipment



On-line technical assistance



Cement balance



Mixer

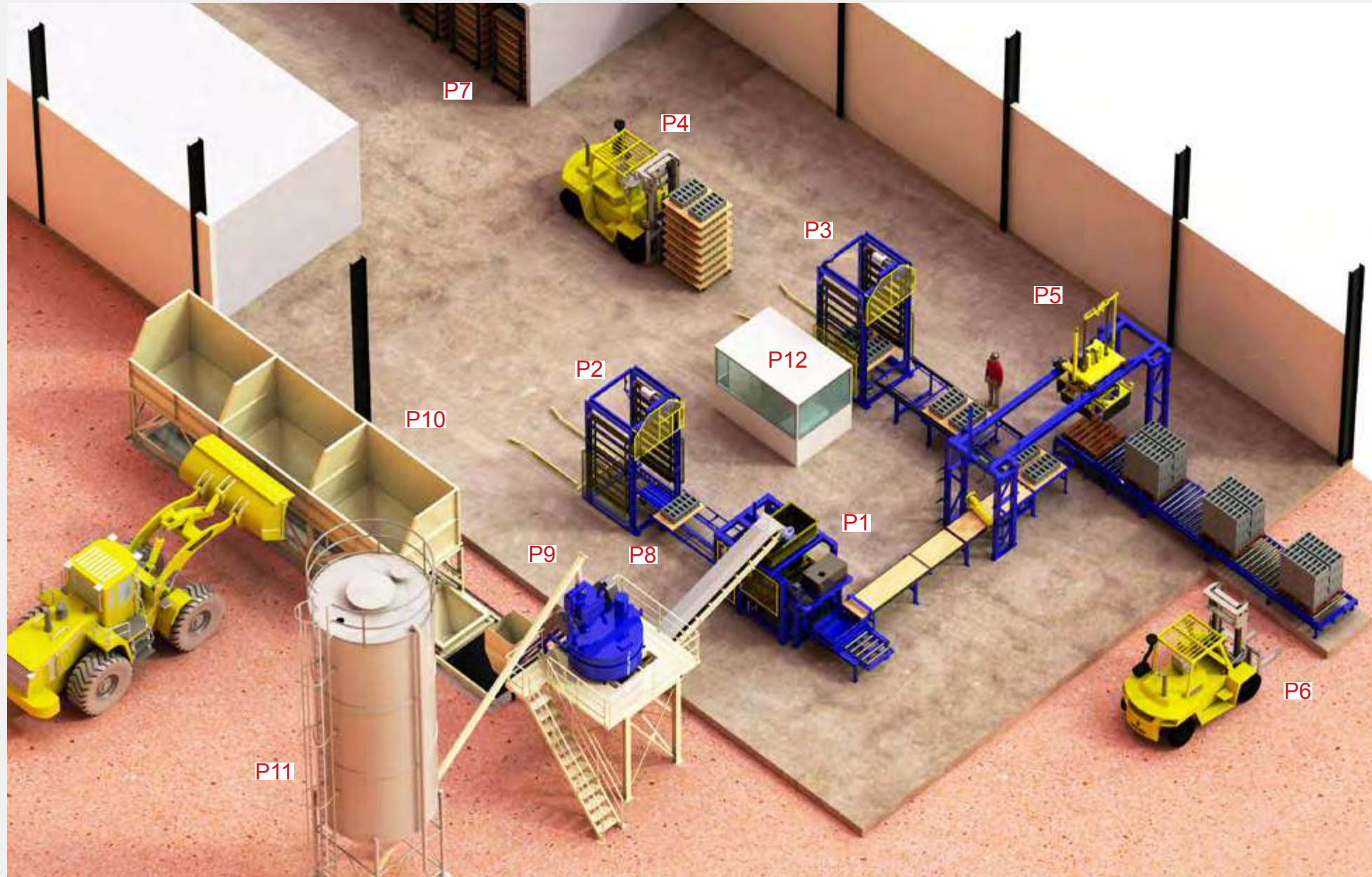

- P1: Machine ROMETA 2010 automatic
- P2: Elevator 8 trays
- P3: Lowerator 8 trays
- P4: Transport to curing area by liftcar
- P5: Automatic packing
- P6: Final product exit

- P7: Curing area
- P8: Planetarium mixer 560 liters
- P9: Electronic cement balance
- P10: Aggregates of 2 or 3 hoppers
- P11: Cement silo
- P12: Control equipment



Packing



Hydraulic equipment

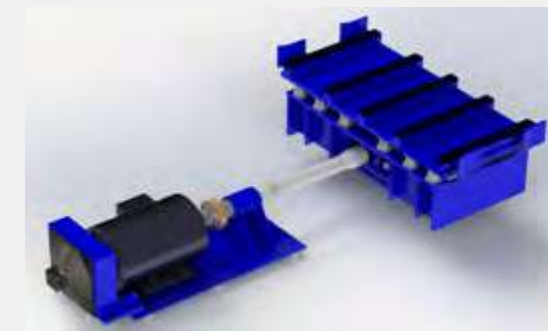

Vibration



Feeding box

OPTIONS ROMETA 2010



Tray turn



Tray brush



Face-mix



Racks feeder

PIECES AND APPLICATIONS

